

ELEVATION ON PLATFORM AND SHELTER

1:100 @ A1

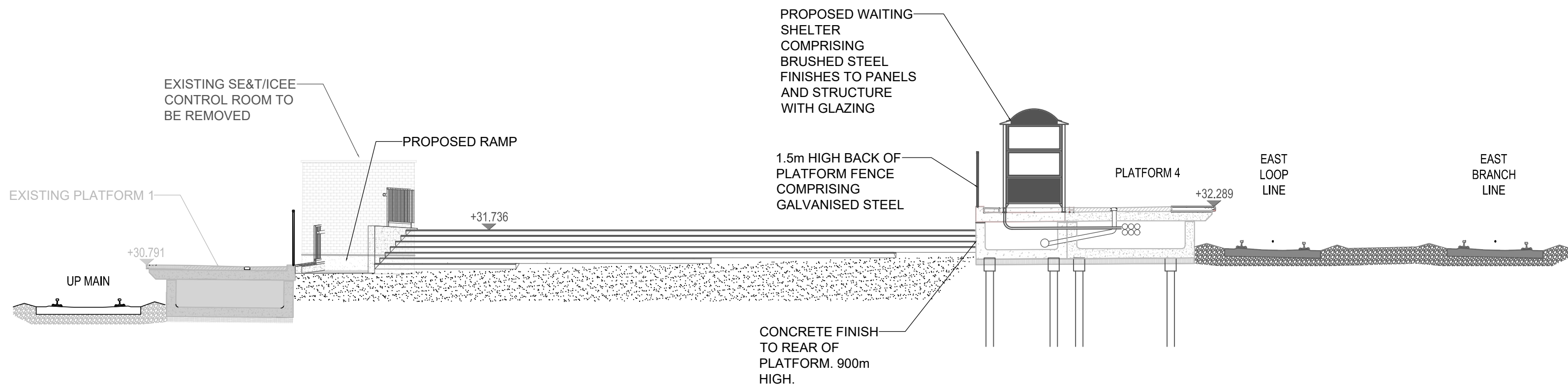

ELEVATION ON CONCOURSE

1:100 @ A1

NOTES

1. ALL MEASUREMENTS ARE IN METRES UNLESS NOTED OTHERWISE.
2. ALL LEVELS ARE IN METRES ORDNANCE DATUM (MOD), UNLESS NOTED OTHERWISE.
3. ANY LOCATIONS OF EXISTING SERVICES/UTILITIES SHOULD BE CONFIRMED ON SITE.
4. THE DART+ COASTAL PROJECT IS POSITIONED ACCORDING TO THE IRISH TRANSVERSE MERCATOR (ITM) COORDINATE SYSTEM.

Disclaimer

© Irish Rail (2023). This drawing is confidential and the copyright in it is owned by Irish Rail. This drawing must not be either loaned, copied or otherwise reproduced in whole or in part or used for any purpose without the prior permission of Irish Rail.

© OpenStreetMap contributors

© Ordnance Survey Ireland and Government of Ireland. All O.S. data used for plans are printed under "Copyright Ordnance Survey Ireland 0038723 (OSI Aerial Data or OSI Lidar Data) & 2023 OSI, NMA, 100 (OSI Vector Data)". All elevations are in metres and relate to OSI Geoid Model (OSGM02) Mean Head as defined by existing Project Control. All Co-ordinates are in Irish Transverse Mercator Grid (ITM) as defined by OSI active GPS station Tallaght College (TLLG).



Rev	Date	Dwn	Chk'd	App'd	Description
P01	20/10/2023	MV	EJ	DB	FOR REVIEW AND COMMENT

Client



Engineering Designer



Project Title

DART+ COASTAL NORTH

Drawing Title

DROGHEDA PLATFORM
ELEVATIONS

Date

20/10/2023

Scale

SHOWN @ A1
SHOWN @ A3

Drawn

MV

Checked

EJ

Approved

DB

Project Code

D+WP56

Originator Code

ARP

QMS Code

280275-00

Drawing File Name

D+WP56-ARP-P4-NL-DR-RO-001315

Sheet Number

01 of 01

Status

S3

Rev

P01

DO NOT SCALE USE FIGURED DIMENSIONS ONLY

C:\bms\arup-eur-pw-01\dms\3696ID-WP56-ARP-P3-NL-M2-CX-0020202.dwg

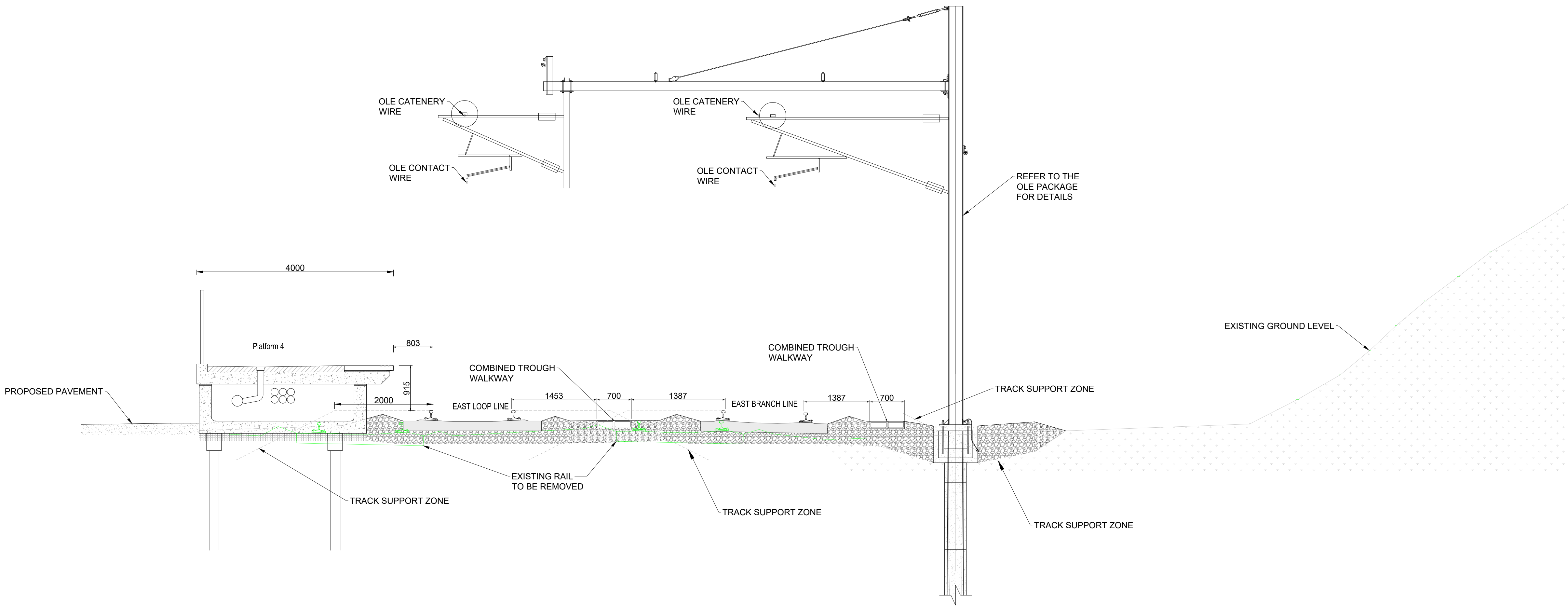

1-1 CROSS SECTION
001310 1:50 @ A1

- NOTES**
- DO NOT SCALE FROM THIS DRAWING
 - LOCATION OF ALL BURIED SERVICES TO BE CONFIRMED PRIOR TO CONSTRUCTION. ANY DISCREPANCIES TO BE HIGHLIGHTED TO THE DESIGN ENGINEER.
 - ALL DIMENSIONS ARE IN METRES, UNLESS OTHERWISE STATED.
 - ALL CHAINAGES ARE IN KILOMETRES.
 - DRAWING TO BE PRINTED IN COLOUR.
 - ALL LEVELS ARE IN METRES ORDNANCE DATUM (mOD) UNLESS OTHERWISE STATED.
 - THE DART+ COASTAL NORTH PROJECT IS POSITIONED ACCORDING TO THE IRISH TRANSVERSE MERCATOR (ITM) COORDINATE SYSTEM.

- LEGEND**
- EXISTING ELEMENTS
 - PROPOSED ELEMENTS
 - ELEMENTS TO BE REMOVED

Disclaimer
© Irish Rail (2023). This drawing is confidential and the copyright in it is owned by Irish Rail. This drawing must not be either loaned, copied or otherwise reproduced in whole or in part or used for any purpose without the prior permission of Irish Rail.
© OpenStreetMap contributors
© Ordnance Survey Ireland and Government of Ireland. All O.S. data used for plans are printed under "Copyright Ordnance Survey Ireland 0038723 (OSi Aerial Data or OSi Lidar Data) & 2023 OSi, NMA, 100 (OSi Vector Data)". All elevations are in metres and relate to OSi Geoid Model (OSGM02) Mean Head as defined by existing Project Control. All Co-ordinates are in Irish Transverse Mercator Grid (ITM) as defined by OSi active GPS station Tallaght College (TLLG).



Rev	Date	Dm	Chk'd	App'd	Description
P01	10/11/2023	SF	EJ	CC	PLANNING ISSUE



Date	Scale SHOWN @ A1 SHOWN @ A3
10/11/2023	
Project Code	Originator Code
D+WP56	ARP



Drawn	Checked	Approved
SF	EJ	CC
QMS Code	280275-00	

Project Title	DART+ COASTAL NORTH			
Drawing Title	DROGHEDA PLATFORM CROSS SECTIONS			
Drawing File Name	Sheet Number	Status	Rev	
D+WP56-ARP-P4-NL-DR-RO-001316	01 of 02	S3	P01	

DO NOT SCALE USE FIGURED DIMENSIONS ONLY

C:\bms\arup-eur-pw-01\dms\664D-WP56-ARP-P4-NL-DR-RO-001317.dwg

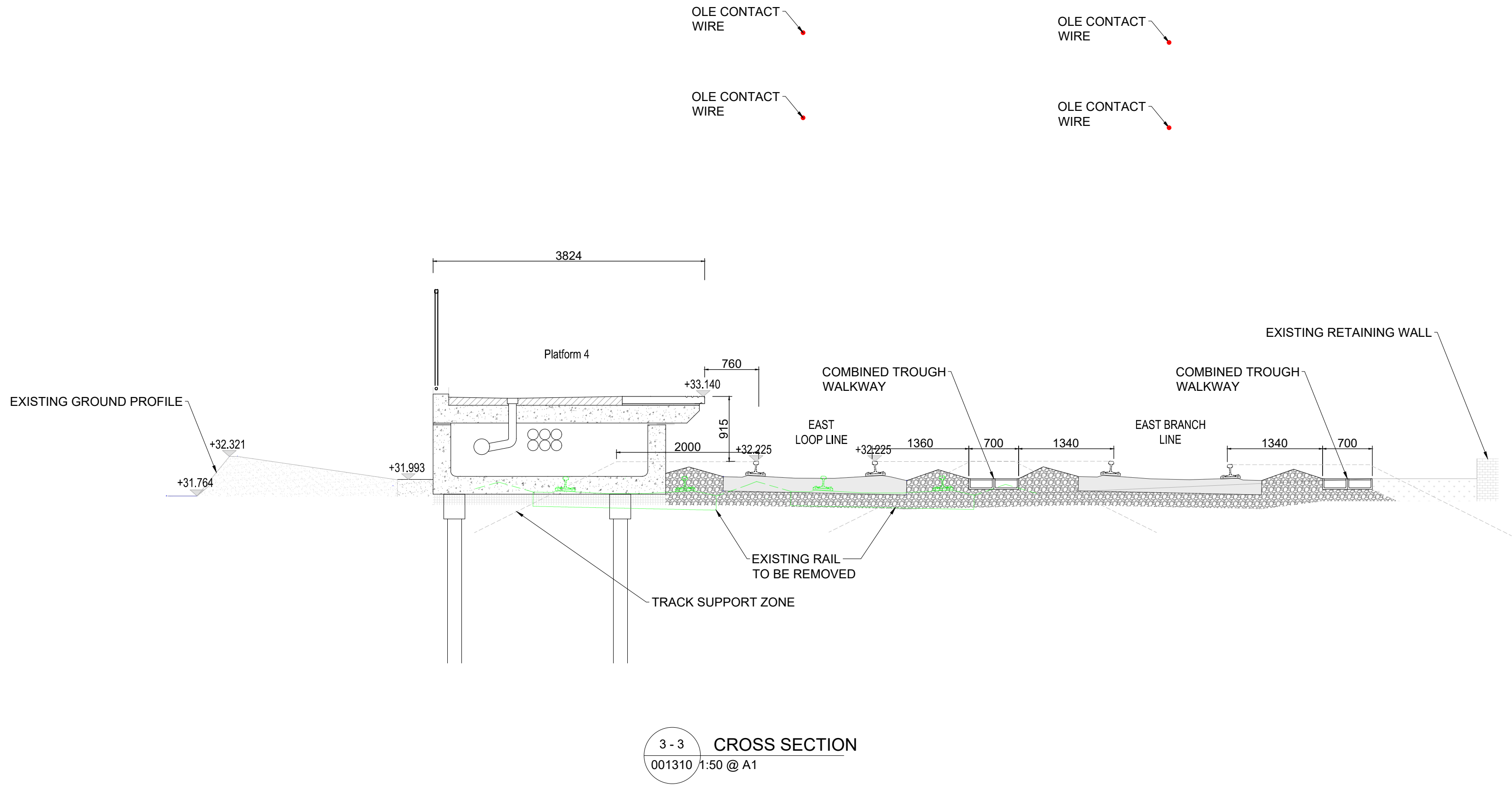
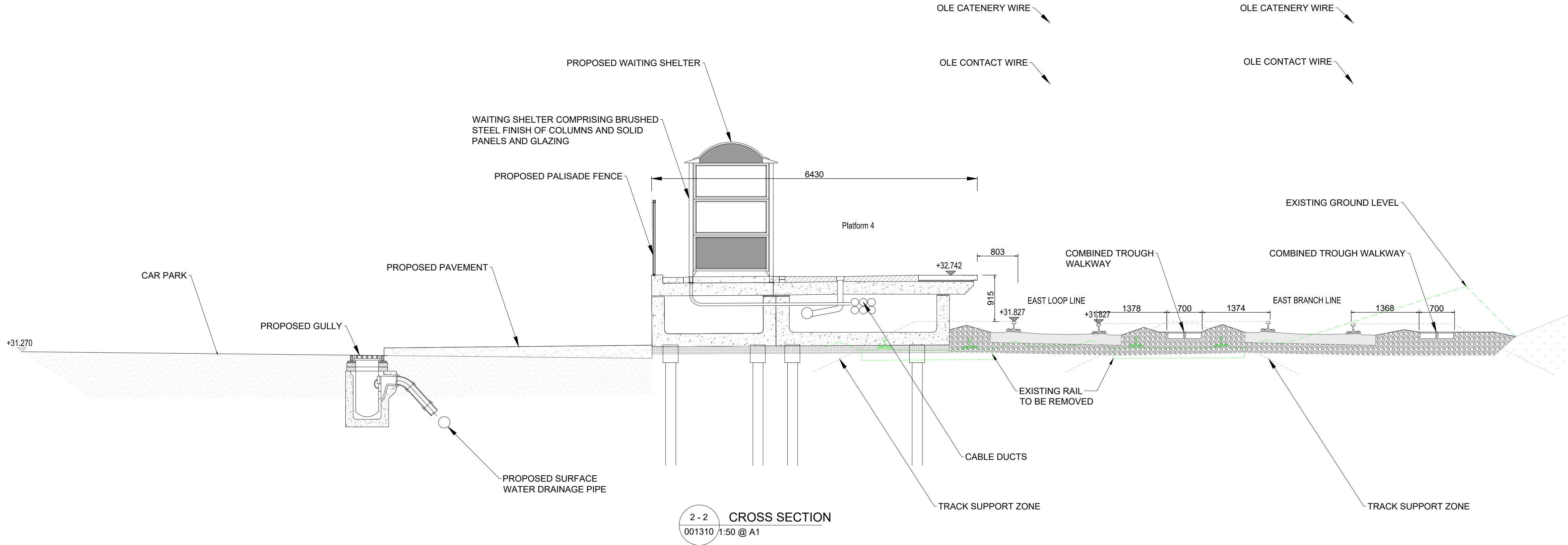

NOTES

- DO NOT SCALE FROM THIS DRAWING.
- REFERENCE TO BE MADE TO THE PERMANENT WAY DESIGN, SIGNALLING STUDY AND OLE STUDY D+WP56-ARD-P3-NL-RP-SL-000001 AND D+WP56-ARP-P3-NL-RP-PW-000008.
- LOCATION OF ALL BURIED SERVICES TO BE CONFIRMED PRIOR TO CONSTRUCTION. ANY DISCREPANCIES TO BE HIGHLIGHTED TO THE DESIGN ENGINEER.
- ALL DIMENSIONS ARE IN METRES, UNLESS OTHERWISE STATED.
- ALL CHAINAGES ARE IN KILOMETRES.
- DRAWING TO BE PRINTED IN COLOUR.
- ALL LEVELS ARE IN METRES ORDNANCE DATUM (mOD) UNLESS OTHERWISE STATED.
- THE DART+ COASTAL NORTH PROJECT IS POSITIONED ACCORDING TO THE IRISH TRANSVERSE MERCATOR (ITM) COORDINATE SYSTEM.

LEGEND

- EXISTING ELEMENTS
- PROPOSED ELEMENTS
- ELEMENTS TO BE REMOVED

Disclaimer
© Irish Rail (2023). This drawing is confidential and the copyright in it is owned by Irish Rail. This drawing must not be either loaned, copied or otherwise reproduced in whole or in part or used for any purpose without the prior permission of Irish Rail.
© OpenStreetMap contributors
© Ordnance Survey Ireland and Government of Ireland. All O.S. data used for plans are printed under "Copyright Ordnance Survey Ireland 0038723 (OSi Aerial Data or OSi Lidar Data) & 2023 OSi, NMA, 100 (OSi Vector Data)". All elevations are in metres and relate to OSi Geoid Model (OSGM02) Mean Head as defined by existing Project Control. All Co-ordinates are in Irish Transverse Mercator Grid (ITM) as defined by OSi active GPS station Tallaght College (TLLG).



Tionscadal Éireann
Project Ireland
2040

Rev	Date	Dn	Chk'd	App'd	Description
P01	10/11/2023	SF	EJ	CC	PLANNING ISSUE

Client



Engineering Designer

ARUP

Project Title

DART+ COASTAL NORTH

Drawing Title

DROGHEDA PLATFORM
CROSS SECTIONS

Date

10/11/2023

Scale

SHOWN @ A1
SHOWN @ A3

Drawn

SF

Checked

EJ

Approved

CC

Project Code

D+WP56

Originator Code

ARP

QMS Code

280275-00

Drawing File Name

D+WP56-ARP-P4-NL-DR-RO-001317

Sheet Number

02 of 02

Status

S3

Rev

P01

DO NOT SCALE USE FIGURED DIMENSIONS ONLY

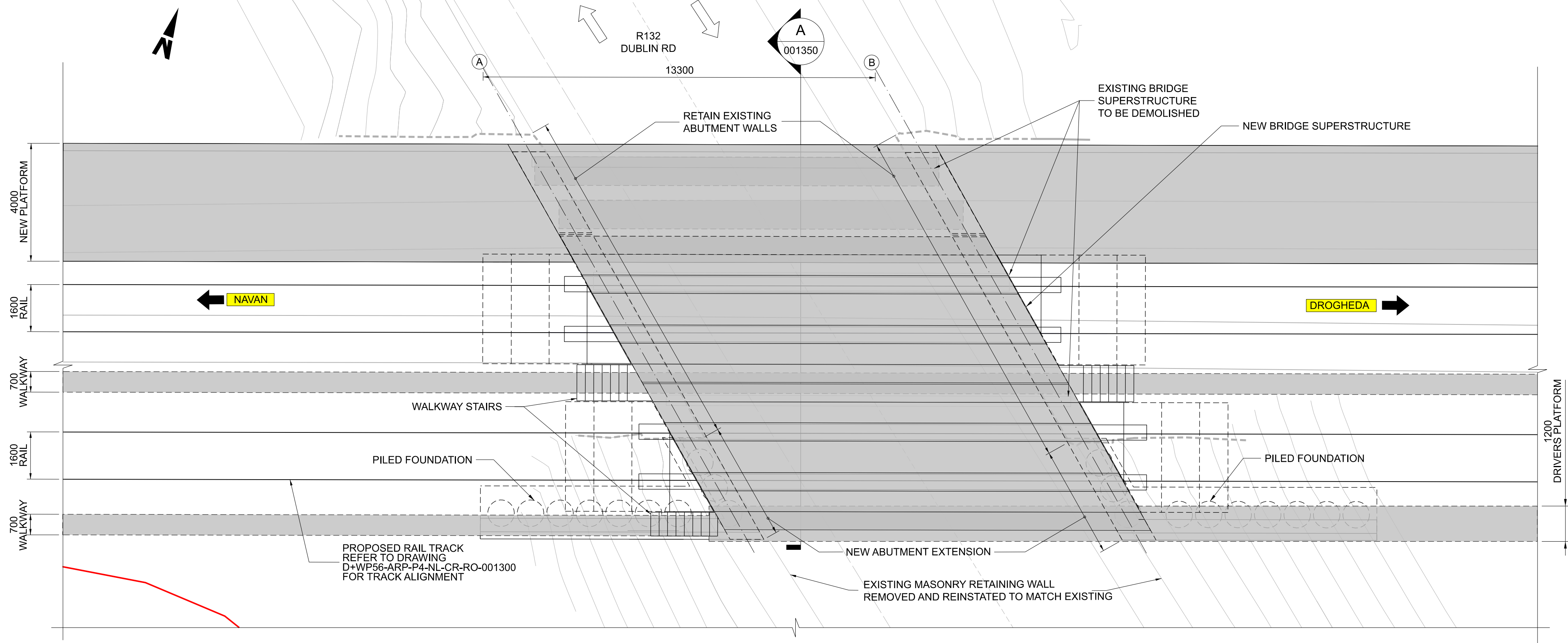

PLAN
001350 1:100

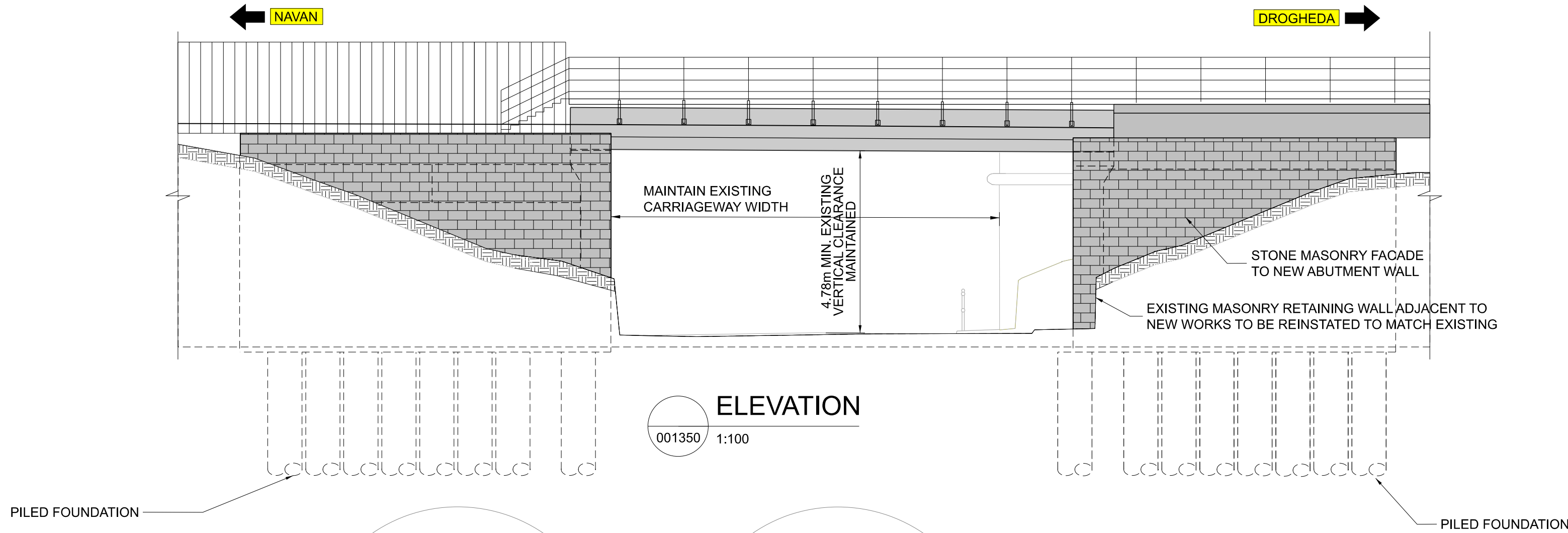

ELEVATION
001350 1:100

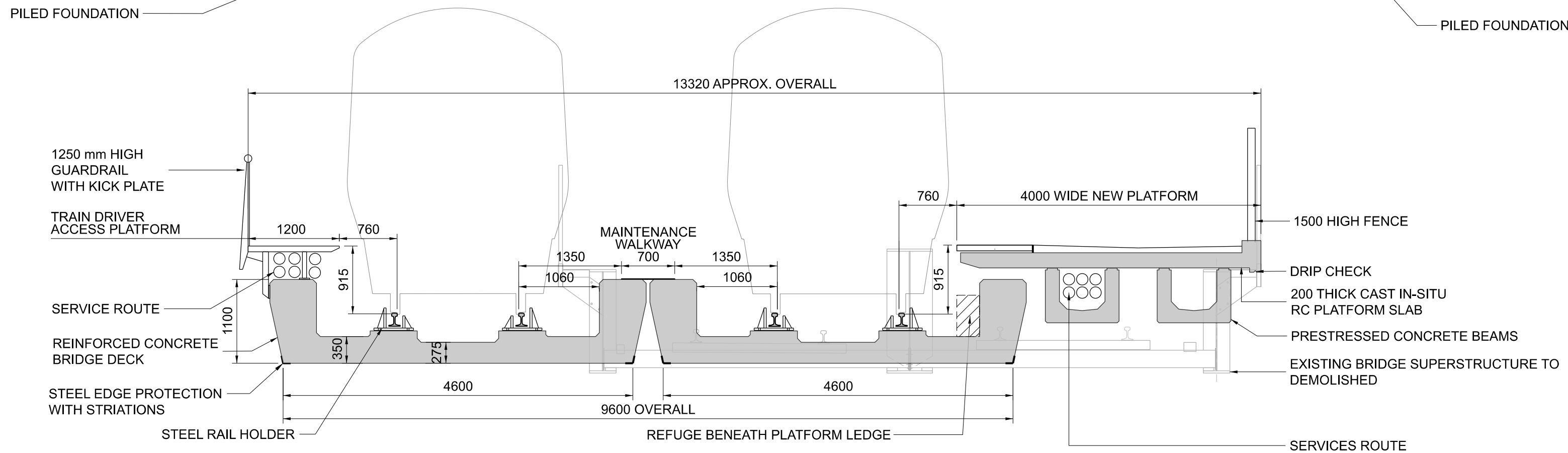

SECTION A
001350 1:50

- NOTES
1. ALL DIMENSIONS ARE SHOWN IN MILLIMETERS UNLESS NOTED OTHERWISE.
 2. ALL LEVELS ARE SHOWN IN METERS ABOVE ORDINANCE DATUM.
 3. DO NOT SCALE FROM THIS DRAWING.
 4. PROPOSED AND EXISTING OVERHEAD LINE EQUIPMENT (OHLE) IS NOT SHOWN IN PLAN OR ELEVATION.
 5. REFER TO BOOK 7 LINEAR WORKS PLANS FOR OHLE AND LINESIDE CIVILS ELEMENTS SHOWN IN PLAN.

- LEGEND
- Proposed elements
 - Existing elements
 - Development boundary

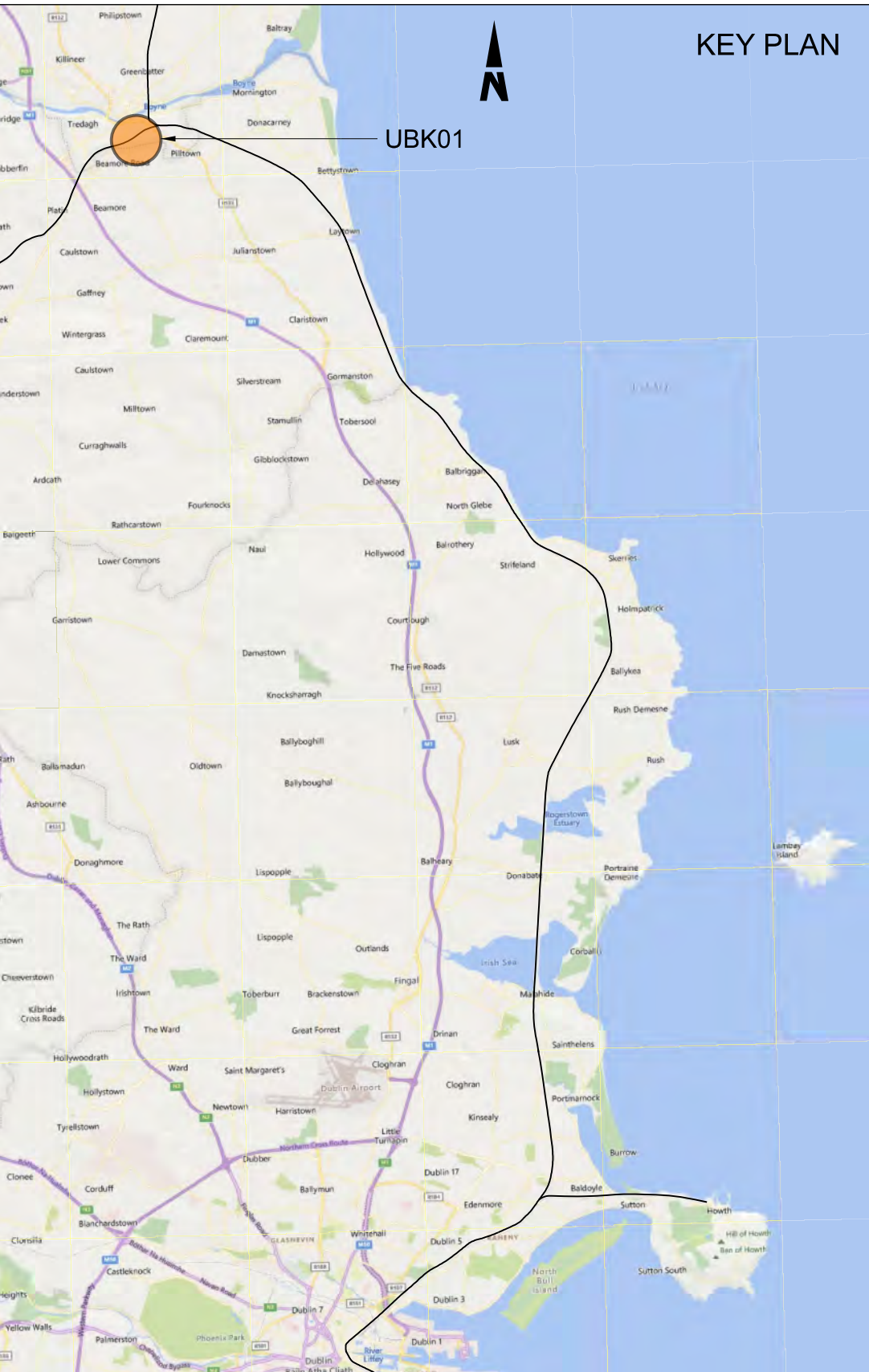

Disclaimer

© Irish Rail (2023). This drawing is confidential and the copyright in it is owned by Irish Rail. This drawing must not be either loaned, copied or otherwise reproduced in whole or in part or used for any purpose without the prior permission of Irish Rail.

© OpenStreetMap contributors

© Ordnance Survey Ireland and Government of Ireland. All O.S. data used for plans are printed under Copyright Ordnance Survey Ireland 0039723 (OSI Aerial Data or OSI Lidar Data) & 2023/OSI_NMA_180 (OSI Vector Data). All elevations are in metres and relate to OSI Geoid Model (OSGM02) Mean Head as defined by existing Project Control. All Co-ordinates are in Irish Transverse Mercator Grid (ITM) as defined by OSI active GPS station Tallaght College (TLLG).



Rev	Date	Dm	Chk'd	App'd	Description
P01	13/10/2023	WC	CG	DB	PLANNING ISSUE

Client		Engineering Designer	
Date	Scale	Drawn	Checked
01/06/2023	SHOWN@ A1 @ A3	WC	CG
Project Code	Originator Code	QMS Code	Approved
D+WP56	ARP	280275-00	DB

Project Title			
DART+ COASTAL NORTH			
Drawing Title			
UBK01 DUBLIN ROAD BRIDGE RECONSTRUCTION GENERAL ARRANGEMENT			
Drawing File Name	Sheet Number	Status	Rev
D+WP56-ARP-P4-NL-DR-RO-001350	01 of 01	S3	P01

DO NOT SCALE USE FIGURED DIMENSIONS ONLY

DROGHEDA MACBRIDE
STATION

NOTES

1. ALL DIMENSIONS ARE SHOWN IN MILLIMETERS UNLESS NOTED OTHERWISE.
2. ALL LEVELS ARE SHOWN IN METERS ABOVE ORDINANCE DATUM.
3. DO NOT SCALE FROM THIS DRAWING.
4. ALL STRUCTURAL STEELWORK SHALL BE DUPLEX STAINLESS STEEL GRADE EN 1.4162.
5. ALL STAINLESS STEEL BOLT AND SCREW CONNECTIONS SHALL BE GRADE A4-70.
6. PROPOSED AND EXISTING OVERHEAD LINE EQUIPMENT (OHLE) IS NOT SHOWN IN PLAN OR ELEVATION.
7. REFER TO BOOK 7 LINEAR WORKS PLANS FOR OHLE AND LINESIDE CIVILS ELEMENTS SHOWN IN PLAN.

LEGEND

- PROPOSED ELEMENTS
- EXISTING ELEMENTS

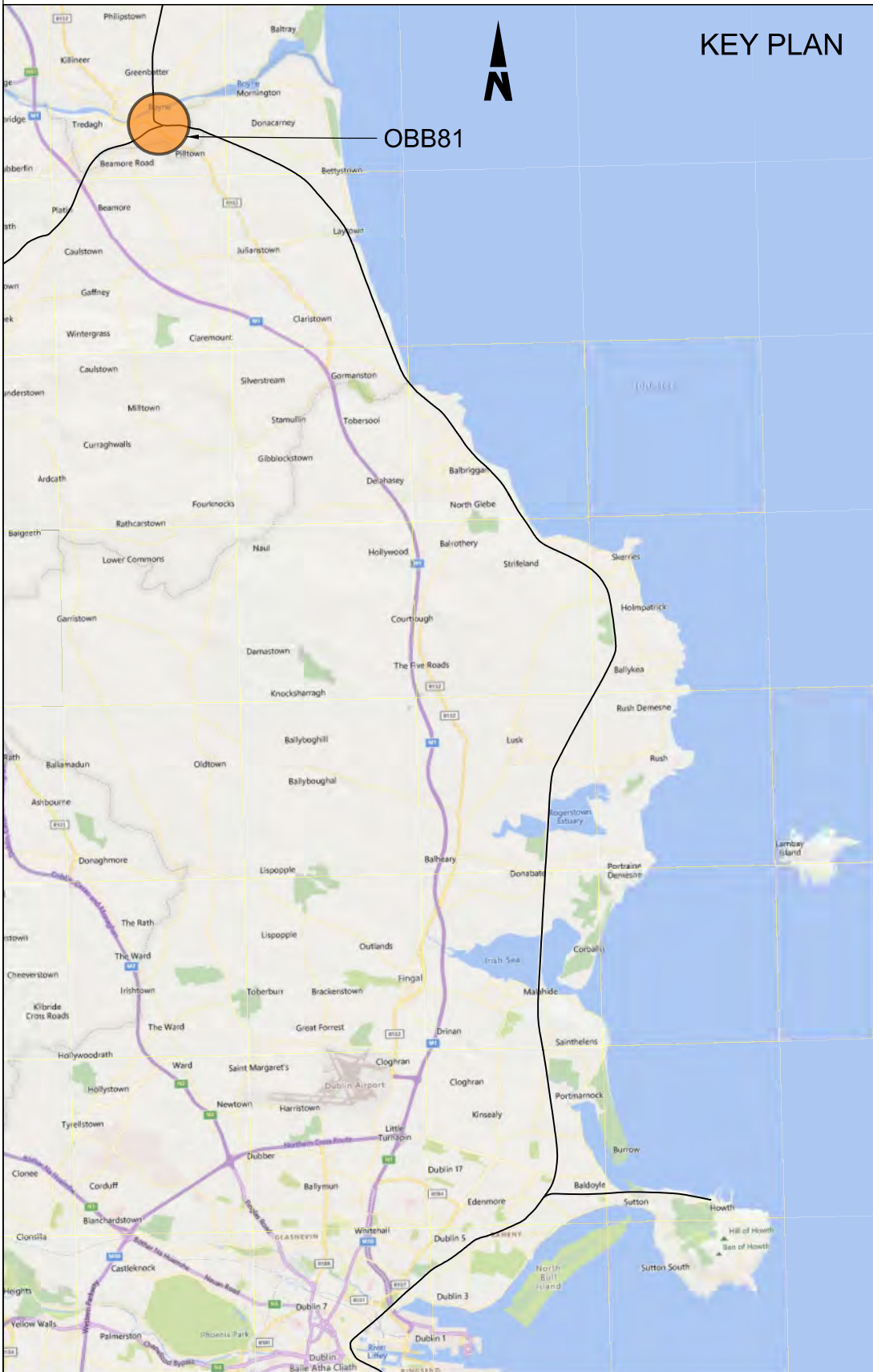
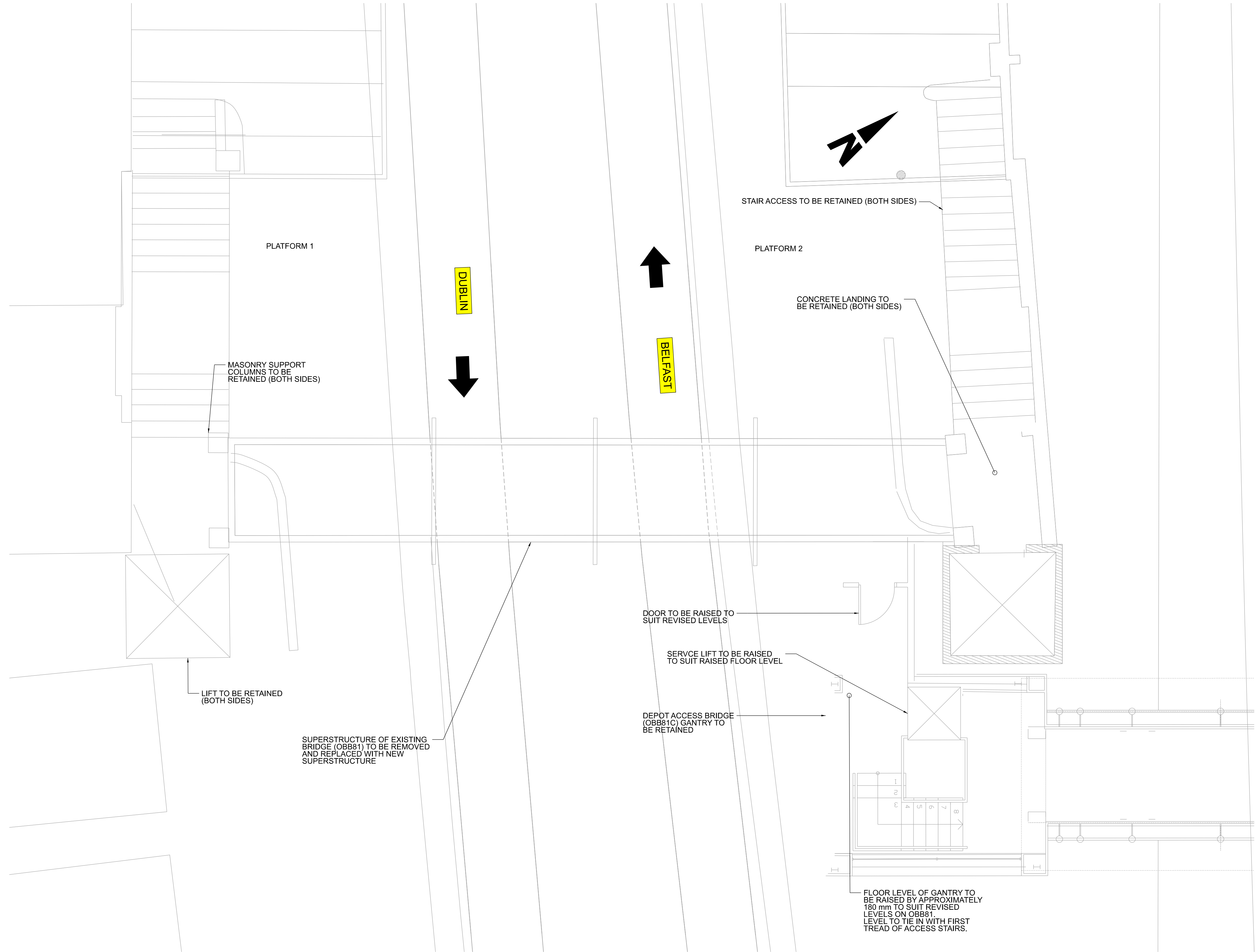

Disclaimer

© Irish Rail (2023). This drawing is confidential and the copyright in it is owned by Irish Rail. This drawing must not be either loaned, copied or otherwise reproduced in whole or in part or used for any purpose without the prior permission of Irish Rail.

© OpenStreetMap contributors

© Ordnance Survey Ireland and Government of Ireland. All O.S. data used for plans are printed under Copyright Ordnance Survey Ireland 0039723 (OSi Aerial Data or OSi Lidar Data) & 2023/OSi_NMA_180 (OSi Vector Data). All elevations are in metres and relate to OSi Geoid Model (OSGM02) Mean Head as defined by existing Project Control. All Co-ordinates are in Irish Transverse Mercator Grid (ITM) as defined by OSi active GPS station Tallaght College (TLLG).



Rev	Date	Dm	Chk'd	App'd	Description
P01	13/10/2023	SF	CG	DB	PLANNING ISSUE

Client		Engineering Designer	
Date	Scale	Drawn	Checked
01/06/2023	@ A1 AS SHOWN @ A3	SF	CG
Project Code	Originator Code	QMS Code	Approved
D+WP56	ARP	280275-00	DB

Project Title			
DART+ COASTAL NORTH			
Drawing Title			
OBB81 - DROGHEDA STATION FOOTBRIDGE GENERAL ARRANGEMENT			
Drawing File Name	Sheet Number	Status	Rev
D+WP56-ARP-P4-NL-DR-RO-001340	01 of 02	S3	P01

DO NOT SCALE USE FIGURED DIMENSIONS ONLY

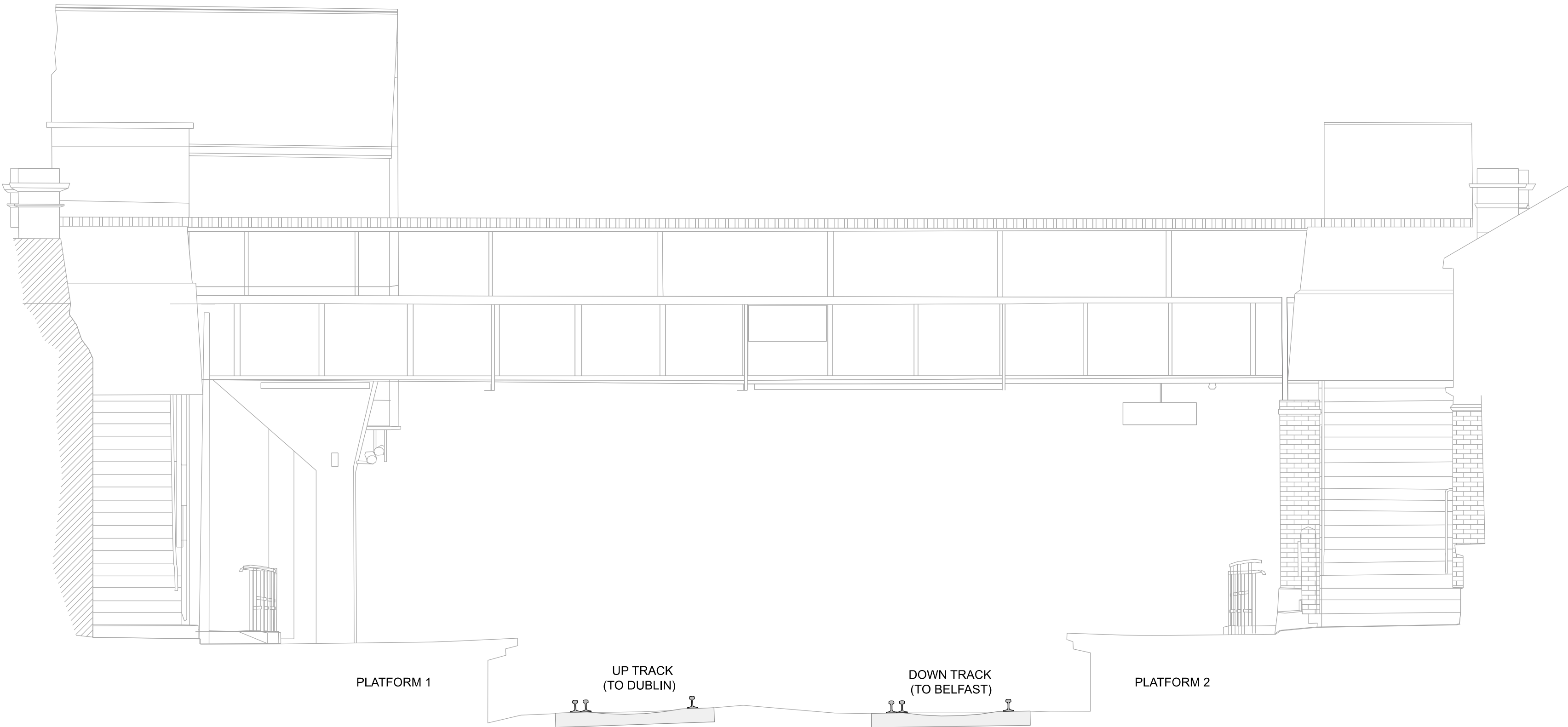

001341 1:50 NORTH ELEVATION - EXISTING

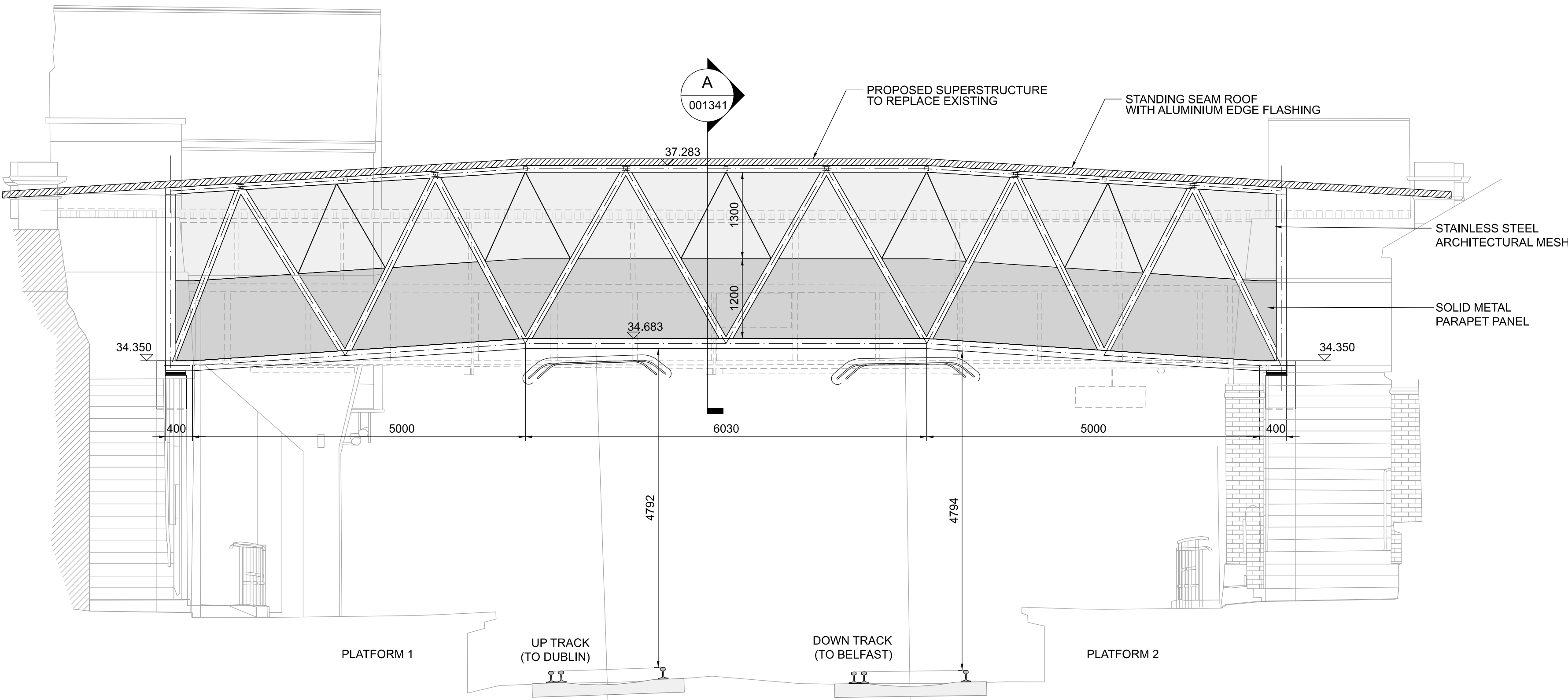

001341 1:50 NORTH ELEVATION - PROPOSED

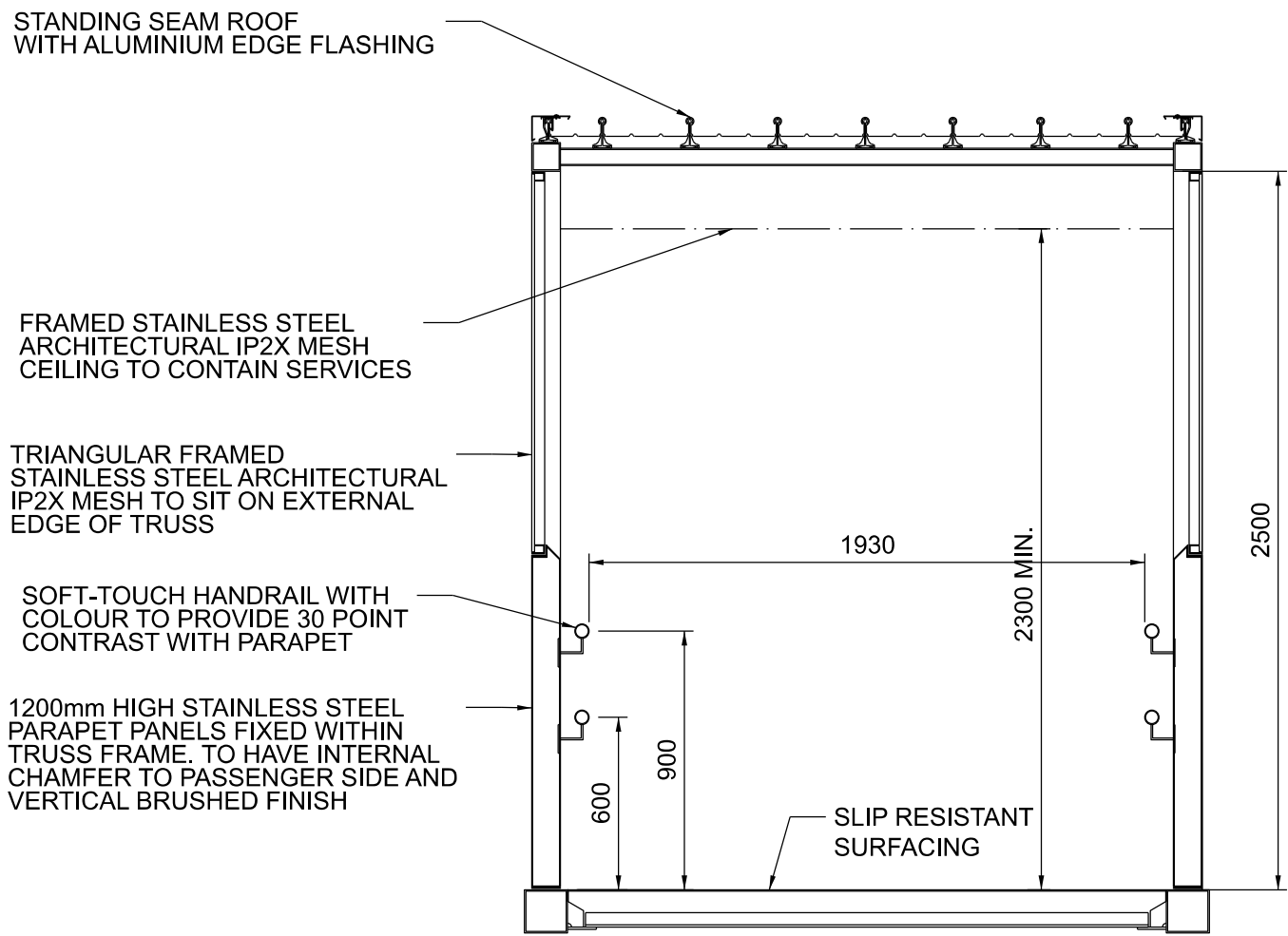

001341 1:25 SECTION A

- NOTES:
- ALL DIMENSIONS ARE SHOWN IN MILLIMETERS UNLESS NOTED OTHERWISE.
 - ALL LEVELS ARE SHOWN IN METERS ABOVE ORDINANCE DATUM.
 - DO NOT SCALE FROM THIS DRAWING.
 - ALL STRUCTURAL STEELWORK SHALL BE DUPLEX STAINLESS STEEL GRADE EN 1.4162.
 - ALL STAINLESS STEEL BOLT AND SCREW CONNECTIONS SHALL BE GRADE A4-70.

- LEGEND
- PROPOSED ELEMENTS
 - EXISTING ELEMENTS

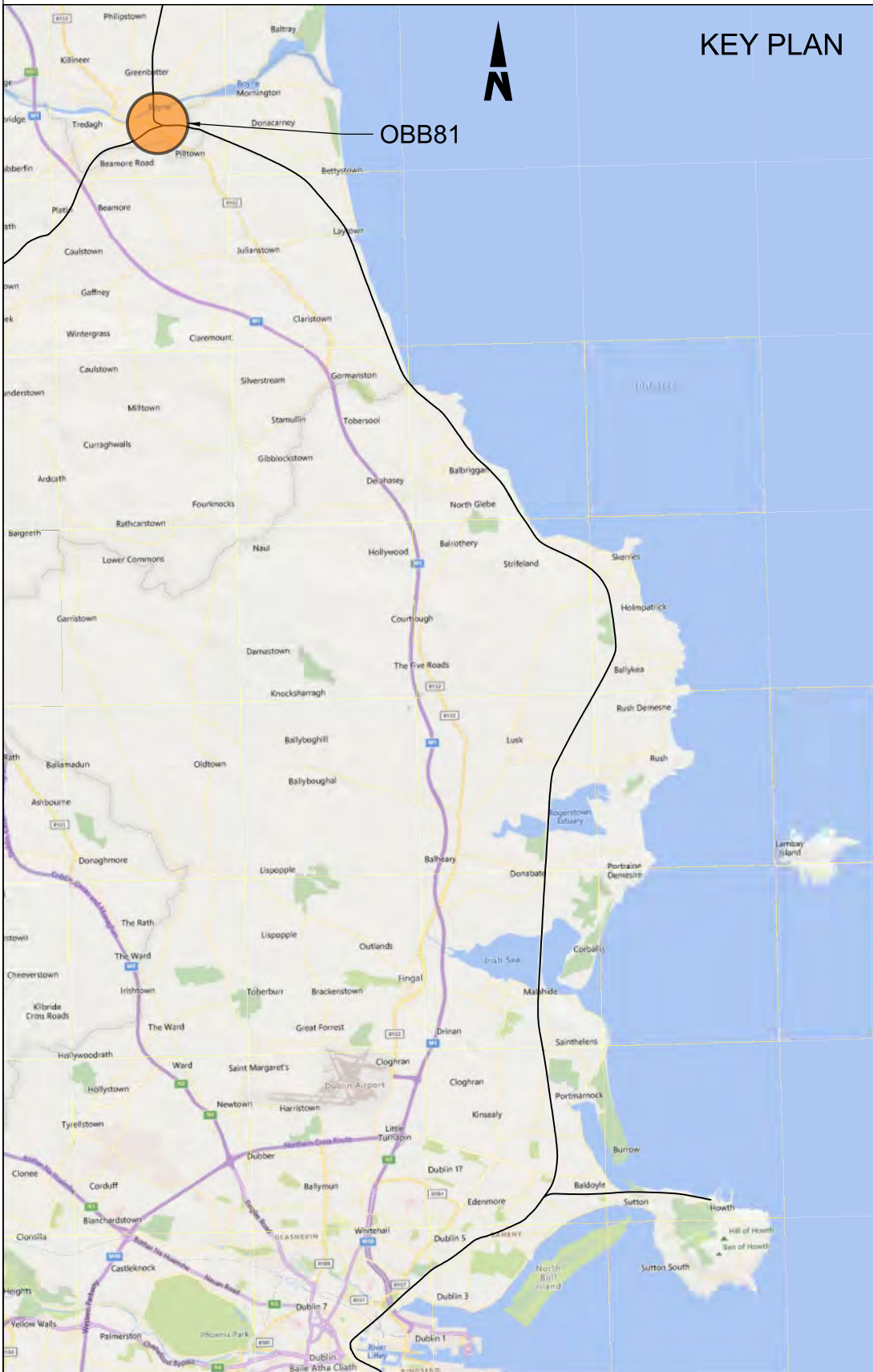

Disclaimer

© Irish Rail (2023). This drawing is confidential and the copyright in it is owned by Irish Rail. This drawing must not be either loaned, copied or otherwise reproduced in whole or in part or used for any purpose without the prior permission of Irish Rail.

© OpenStreetMap contributors

© Ordnance Survey Ireland and Government of Ireland. All O.S. data used for plans are printed under Copyright Ordnance Survey Ireland 0039723 (OSI Aerial Data or OSI Lidar Data) & 2023/OSI_NMA_190 (OSI Vector Data). All elevations are in metres and relate to OSI Geoid Model (OSGM02) Mean: Head as defined by existing Project Control. All Co-ordinates are in Irish Transverse Mercator Grid (ITM) as defined by OSI active GPS station Tallaght College (TLLG).



Rev	Date	Dm	Chk'd	App'd	Description
P01	13/10/2023	SF	CG	DB	PLANNING ISSUE

Client		Engineering Designer	
Date	Scale	Drawn	Checked
01/06/2023	@ A1 AS SHOWN @ A3	SF	CG
Project Code	Originator Code	QMS Code	Approved
D+WP56	ARP	280275-00	DB

Project Title			
DART+ COASTAL NORTH			
Drawing Title			
OBB81 - DROGHEDA STATION FOOTBRIDGE ELEVATIONS			
Drawing File Name	Sheet Number	Status	Rev
D+WP56-ARP-P4-NL-DR-RO-001341	02 of 02	S3	P01

DO NOT SCALE USE FIGURED DIMENSIONS ONLY

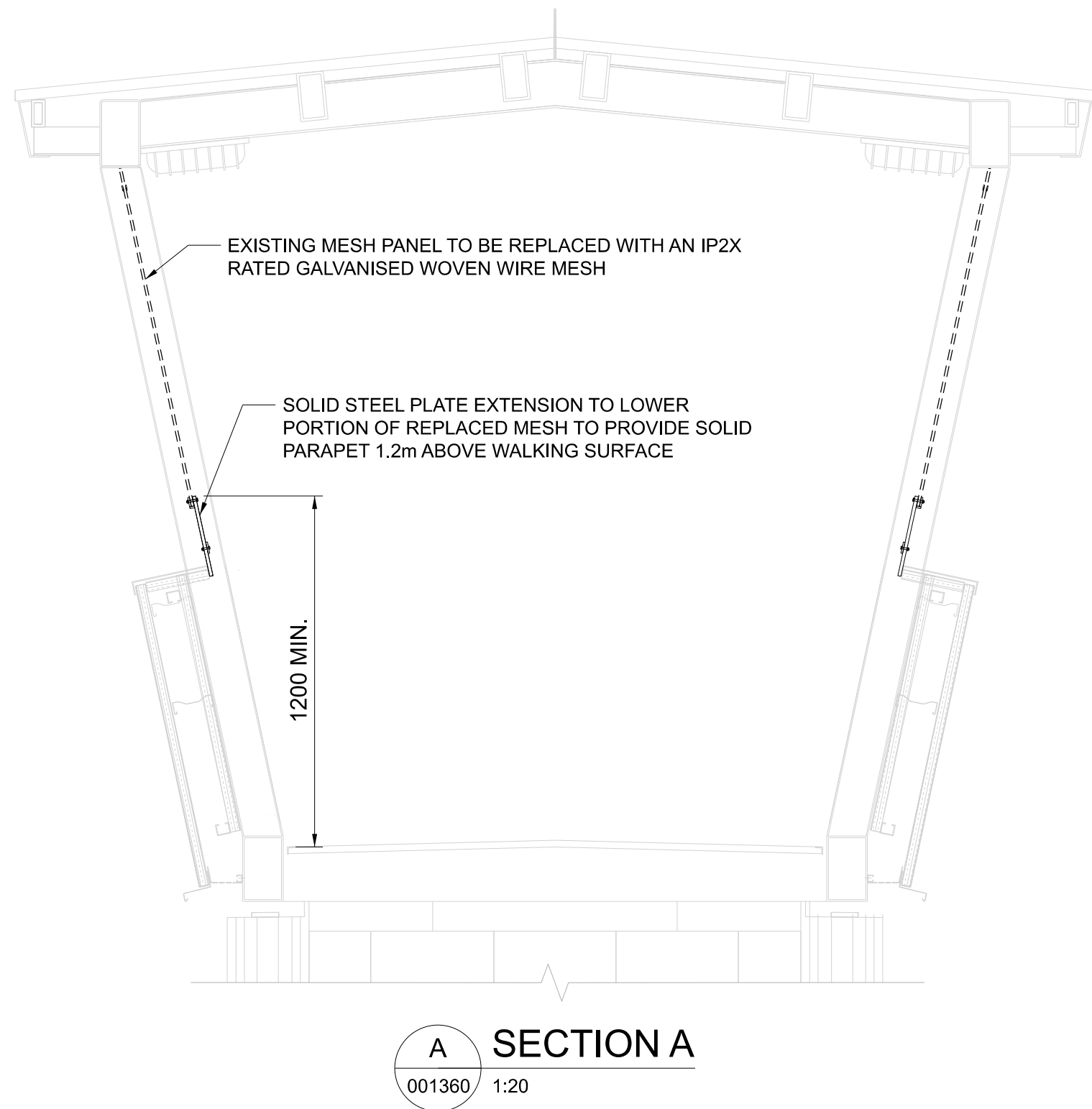
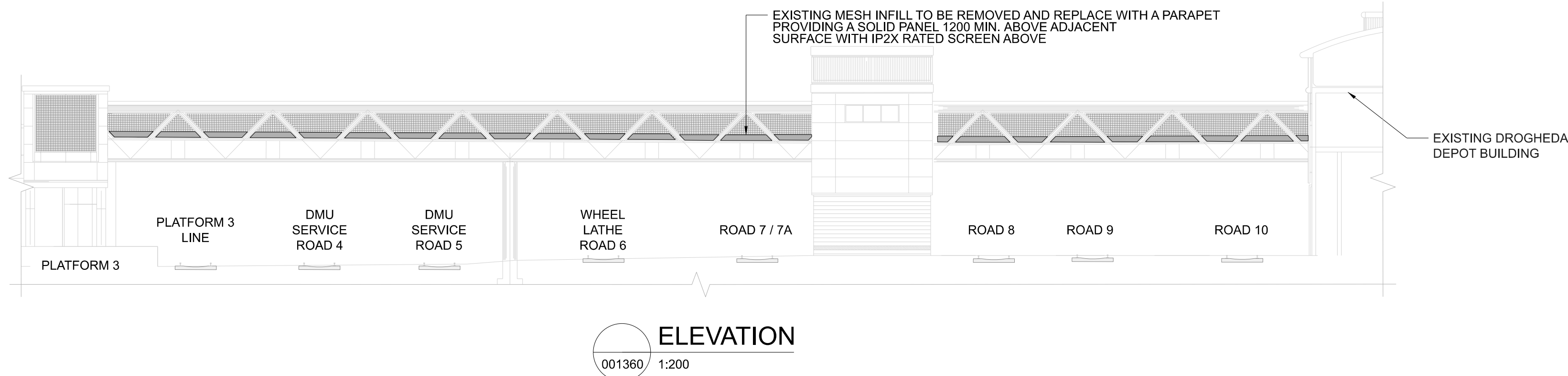
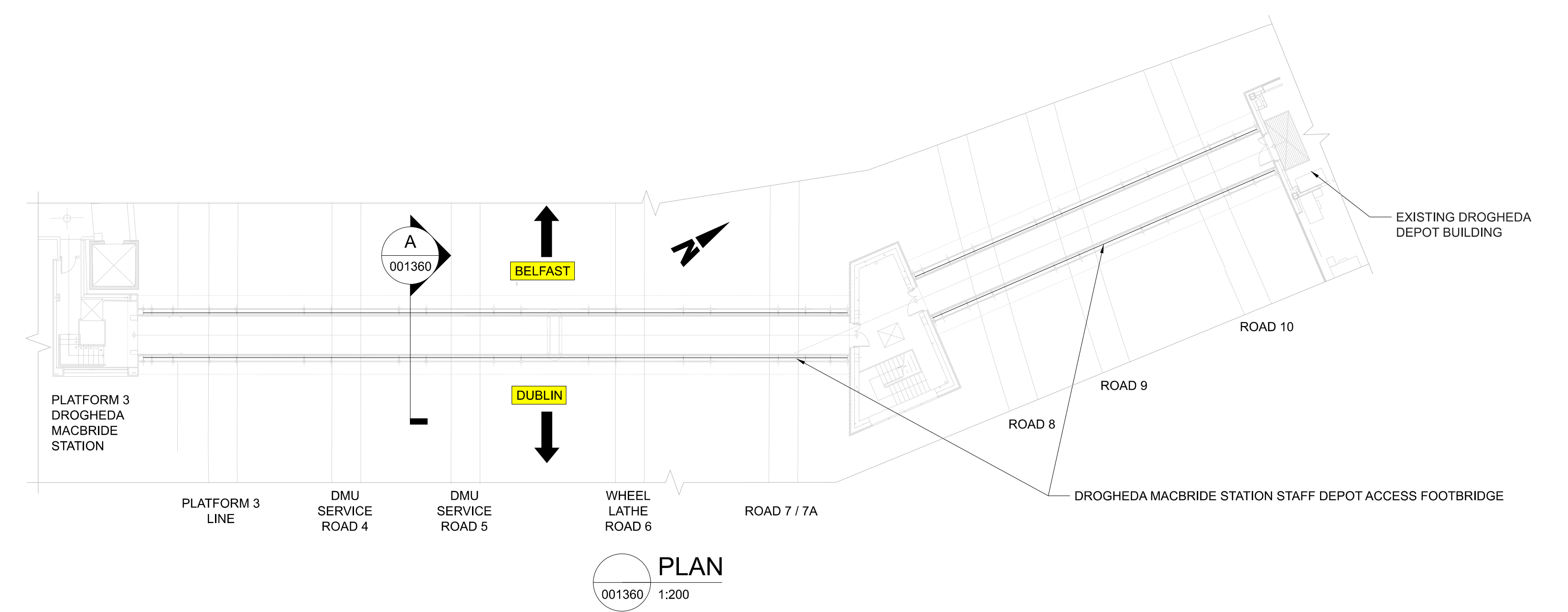

NOTES

1. ALL DIMENSIONS ARE SHOWN IN MILLIMETERS UNLESS NOTED OTHERWISE.
2. ALL LEVELS ARE SHOWN IN METERS ABOVE ORDINANCE DATUM.
3. DO NOT SCALE FROM THIS DRAWING.
4. ALL STEELWORK SHALL BE GRADE S355 UNLESS NOTED OTHERWISE.
STEELWORK SHALL CONFORM TO THE FOLLOWING STANDARDS:
UB & UC SECTIONS - BS EN 10025
PFC & PLATES - BS EN 10025
RHS, SHS & CHS - BS EN 10210
EQUAL & UNEQUAL ANGLES - BS EN 10056
FLAT, SQUARE & ROUND BAR - BS EN 10025
5. ALL WELDED CONNECTIONS SHALL BE GRADE S355 UNLESS NOTED OTHERWISE.
6. ALL BOLT ASSEMBLIES SHALL BE OF PROPERTY CLASS 8.8 UNLESS NOTED OTHERWISE, WITH HEXAGONAL HEADED BOLTS CONFORMING TO BS EN 4014, NUTS TO BS EN 4032 AND HIGH STRENGTH STEEL WASHERS TO BS EN 7091.
7. ALL STEELWORK SHALL BE HOT DIP GALVANISED IN ACCORDANCE WITH IS EN ISO 1461.
8. PROPOSED AND EXISTING OVERHEAD LINE EQUIPMENT (OHLE) IS NOT SHOWN IN PLAN OR ELEVATION.

LEGEND

- EXISTING ELEMENTS
- PROPOSED ELEMENTS

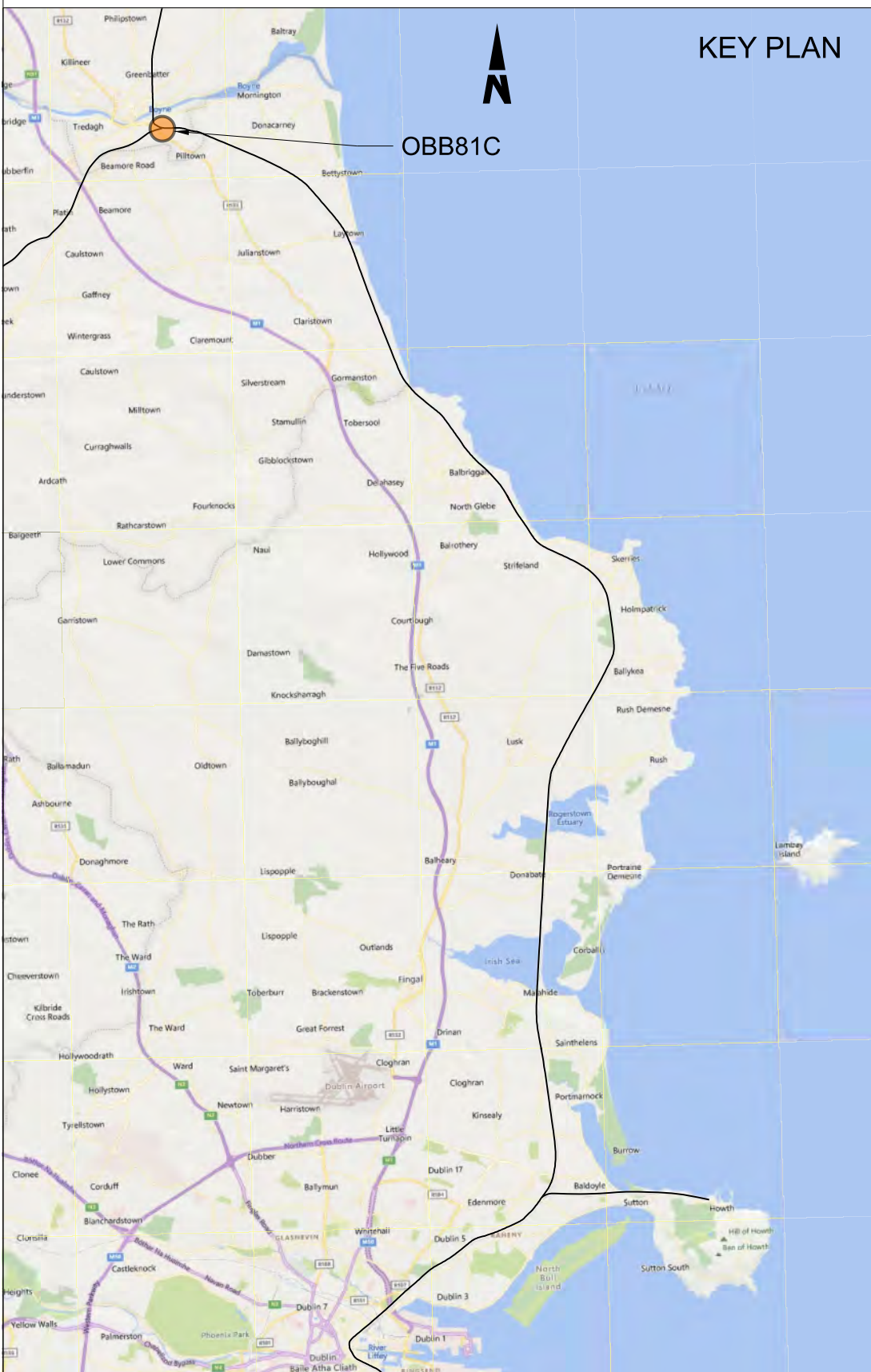

Disclaimer

© Irish Rail (2023). This drawing is confidential and the copyright in it is owned by Irish Rail. This drawing must not be either loaned, copied or otherwise reproduced in whole or in part or used for any purpose without the prior permission of Irish Rail.

© OpenStreetMap contributors

© Ordnance Survey Ireland and Government of Ireland. All O.S. data used for plans are printed under Copyright Ordnance Survey Ireland 0039723 (OSi Aerial Data or OSi Lidar Data) & 2023/OSi_NMA_190 (OSi Vector Data). All elevations are in metres and relate to OSi Grid Model (OSGM02) Malin Head as defined by existing Project Control. All Co-ordinates are in Irish Transverse Mercator Grid (ITM) as defined by OSi active GPS station Tallaght College (TLLG).



Rev	Date	Dm	Chk'd	App'd	Description
P01	13/10/2023	WC	CG	DB	PLANNING ISSUE

Client



Engineering Designer



Project Title

DART+ COASTAL NORTH

Drawing Title

OBB81C DROGHEDA DEPOT STAFF ACCESS FOOTBRIDGE
PARAPET MODIFICATIONS
GENERAL ARRANGEMENT

Date

01/06/2023

Scale

As Shown @ A1 @ A3

Drawn

AS

Checked

CG

Approved

DB

Project Code

D+WP56

Originator Code

ARP

QMS Code

280275-00

Drawing File Name

D+WP56-ARP-P4-NL-DR-RO-001360

Sheet Number

01 of 01

Status

S3

Rev

P01

DO NOT SCALE USE FIGURED DIMENSIONS ONLY